

Maple Island

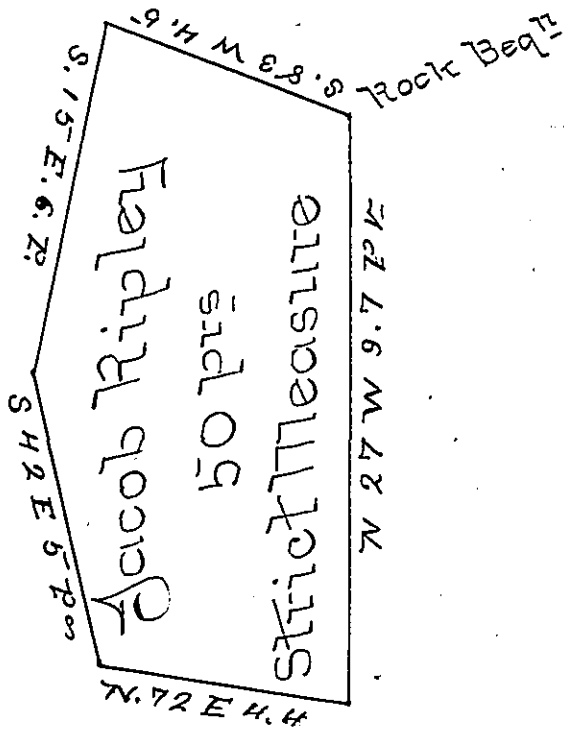

Hancock County Shore

Draught of Fair view Island situate in the River  
 Susquehanna, in Conestogo Township Hancock County  
 opposite land of Conrad Hebble on the Hancock Shore,  
 about sixty yards East of the head of Maple Island and at  
 the foot of Woosingers falls - Containing Fifty perches,  
 Strict Measure - Surveyed in pursuance of a Warrant,  
 granted to Jacob Ripley, dated the 25<sup>th</sup> Day of August A.D.  
 1820 -

J. James Black D.S.

To Jacob Spangler Esq: }  
 Surveyor Genl: }

IN TESTIMONY that the above is a copy of the original remaining on file in  
 the Department of Internal Affairs of Pennsylvania, made  
 conformably to an Act of Assembly approved the 16th day of  
 February, 1833, I have hereunto set my Hand and caused  
 the Seal of said Department to be affixed at Harrisburg,  
 this sixth day of June 1899 -

*James W. Latta*  
 Secretary of Internal Affairs.